



Your guide to
Emerald Princess



Contents

- 3 Emerald Princess at a glance
- 4 MedallionClass
- 5 MedallionClass App
- 6 Onboard Dining
- 7 Onboard Wellness
- 8 Activities & Entertainment
- 9 -10 Accomodation
- 11-12 Deck Plans
- 13 Contact Us





Quick Facts

Refurbished in 2019
 3,080 guests
 1,200 crew
 113,561 tons
 951ft long
 195ft high
 19 decks
 1,539 staterooms
 11 April 2007 Inaugural Cruise

Emerald Princess at a glance

The Detail:

- Inaugural Cruise: April 11, 2007
- Last Refurbished: December 2015
- Christeners: Florence Henderson, Marion Ross, Erin Moran & Susan Olsen (television's favorite mothers & daughters)
- Number of Crew: 1,200
- Guest Services: The Sanctuary, Movies Under the Stars poolside screen, Lotus Spa and Fitness Center, Piazza Atrium, Gatsby's Casino, Sports Deck, Wedding Chapel, Kid's and Teen's Centers, Internet Café, Photo/Video Gallery, Library Art Gallery, The Princess Shops, Guest Services Desk, Shore Excursions Desk, Medical Center
- Showrooms/Lounges: Princess Theater, Explorers Lounge, Wheelhouse Bar, Skywalkers Nightclub, Club Fusion, Adagio Bar, Crooners Bar, Speakeasy Cigar Lounge
- Lifeboats: 18 lifeboats, 6 tenders, 2 rescue boats
- Builder: Fincantieri Cantieri Navali Italiani, Monfalcone, Italy
- Registry: Bermuda
- Pools: 4
- Whirlpools Spas: 7

How Big?

- Guest Capacity: 3,080 lower berths
- Tonnage: 113,561
- Length: 951 feet
- Height: 195 feet
- Number of Decks: 19

Cabins

- Guest Cabins: 1,539 total
- 26 Suites with private balconies - Square footage: 319-689*
- 2 Family Suites - Square footage: 607*
- 178 Mini-suites with private balconies - Square footage: 370-536*
- 675 Balcony cabins - Square footage: 233-273*
- 222 Ocean view cabins - Square footage: 158-182
- 436 Inside cabins - Square footage: 163
- 31 Wheelchair Accessible Cabins

*includes balcony



MedallionClass™

featuring the Medallion™



What is the Medallion?

The Medallion is a revolutionary, wearable device that enables an entirely new level of service and personalised attention onboard a MedallionClass ship and is given to all guests for free. The Medallion facilitates the enhanced guest experience but has no discernible technology – no on-off switch, no charging, no menu to navigate. The Medallion holds a guest's unique digital identity and communicates with readers onboard as well as in select ports and provides crew members with information about each guest to help them provide a better service.



What does it do?

- A streamlined embarkation and disembarkation process, giving quicker and easier access to the ship
- Enhanced interaction with crew members and other guests, e.g. staff can see guest's individual food and beverage preferences and offer a more personalised service
- On demand beverage delivery, whereby guests will be able to order drinks and have them delivered directly throughout the ship and to their stateroom
- OceanCompass, which provides interactive directions throughout the ship and allows guests to easily locate friends, family and their children
- Easy payment for merchandise, drinks, shore excursions and other onboard services
- Access for guests to their real-time itinerary via portals throughout the ship, along with events and activities taking place during their cruise
- Keyless stateroom access
- Interactive games that can be played on portals across the vessel and the top deck 'Movies Under The Stars' screen, including trivia challenges and a ship-wide digital scavenger hunt
- A selection of casino games including poker, bingo and roulette available via guests' smart devices and select portals
- And much much more!

[CLICK HERE TO FIND OUT MORE AND VIEW VIDEOS](#)

All ships in the Princess fleet are MedallionClass.*

MedallionClass features may vary by ship, and are subject to change. Guests on MedallionClass voyages will only be able to get OceanReady within 1-2 months prior to sailing.



Dine My Way

Dine My Way is all about personalising your cruise dining experience. Customise your dining time for each day via the MedallionClass app, whether making reservations for the main dining room (which is included) or speciality restaurants (which charge a small cover charge). Have dinner at the same time each night or change it based on what works for you. Once onboard, you can order food and drinks for delivery wherever you are through OceanNow®. More options at your fingertips means less time waiting and more time to dine your way.



The MedallionClass™ App

The all-in-one app interacts with your Medallion to put the MedallionClass digital experiences at your fingertips. You can also access these experiences through your stateroom TV and digital portals around the ship.

[CLICK HERE TO VIEW APP VIDEO](#)



Expedite your boarding

With OceanReady® boarding is a breeze. Save time by uploading your passport and other travel documents, take your security photo in advance. OceanReady® shifts you into holiday mode faster than ever before thanks to a streamlined arrival process that lets you board more quickly.



Find your way

OceanCompass leverages the Medallion to enable point-to-point way finding across the ship thanks to an intelligent navigation assistant – similar to GPS app. Available on portals around the ship or via the MedallionClass app, OceanCompass guides you throughout the ship, providing directional information so you can seamlessly navigate to your next location, as well as easily locate and chat with friends and family onboard using ShipMates.



Service on demand

With OceanNow, you can enjoy personalised service on-demand by ordering food, drink and retail items to wherever you are onboard. Simply open OceanNow, place your order, then sit back and relax whilst a crew member finds you. Your Medallion tells crew members your exact location - so even if you move, your order will come to you.

Onboard Dining

SPECIALITY

Crown Grill Named one of the 'Best Cruise Ship Steakhouses', this refined steakhouse serves premium aged beef and fresh seafood all cooked in an open theatre-style kitchen and served in an elegant dining room.

Sabatini's Italian Trattoria We've added more of what you love to our award-winning Sabatini's speciality restaurant. With both modern and rustic flair, experience antipasti and handmade pasta dishes by celebrity chef, Angelo Auriana. You can also enjoy treasured family recipes from our Italian chefs across the fleet, plus exquisite Italian wines and cocktails.

Steamers Our family-style seafood restaurant offers dinner served by wait staff for a nominal fee. Choose from Black & Blue Mussels or Classic Clams "Steamers" and other seafood favorites. All come with generous sides and dipping sauces as well as starters and dessert.

Salty Dog Gastropub A warm, inviting gastropub experience inspired by pub favourites. Gather in a comfortable, pub style atmosphere to share distinctive dishes. Offering a unique variety of beer, whiskey and cocktail selections, plus live music, there's something for everyone at this hip, friendly twist on traditional pub fare.

Vines Voted one of the 'Best Wine Bars at Sea', wine lovers can pair an extensive selection of delectable tipples with anything from fresh sushi and tapas to artisan meats and cheeses.



Planks BBQ Drop by for a classic American-style dinner, served by wait staff for a nominal fee. Our casual barbecue restaurant gives you a choice of "Planks" loaded with four meats, chili, coleslaw and seasoned fries along with starters and decadent dessert.

Ultimate Balcony Dining A luxurious breakfast or dinner experience at sea all served right on the privacy of your own balcony. Treat yourself to the unparalleled indulgence and savour food, views, and memories that will never be forgotten.

INCLUDED

World Fresh Marketplace This laid-back setting is ideal for a quick breakfast, informal lunch, or casual dinner. Complimentary tea, coffee and homemade lemonade are available here.

International Café Situated in the Piazza, this is the perfect place to watch the world go by and enjoy complimentary snacks around the clock.

Slice Pizzeria Our top-deck pizzeria features a bold new look that sets the stage for tempting toppings and classic favourites.

Coffee & Cones Complimentary ice cream cones await you at our top-deck creamery venue. Pick up a chocolate cone, a vanilla, or a combination. Or treat yourself to an ice cream sandwich, with a tempting choice of flavours.

24 hour room service This is more than room service; it's anywhere service! 24-hour free delivery is at your fingertips with OceanNow no matter where you are or what you need.

Onboard Wellness



Freshwater Pools Take a dip in our sparkling freshwater pools and leave your everyday world behind. Unwind on a padded lounge and soak up the sun, catch up on reading, listen to music or dream of your next adventure on board or ashore.

The Sanctuary The Sanctuary is a luxurious spa-inspired top-deck retreat, reserved only for adults and featuring plush lounge furniture, attentive stewards, soothing music and healthy beverages and food. Find private cabanas where you can enjoy a delightful treatment.

Private Cabanas With eight private cabanas at The Sanctuary— twice as many as our other Royal Class ships — Emerald Princess offers even more opportunities to indulge in a private getaway at our exclusive adults-only retreat. Relax with signature drinks, light meals, and alfresco massages. Serenity Stewards attend to your

every need, whether it's to be on hand to provide chilled face towels or Evian water mist spray.

Lotus Spa Revitalise in the Lotus Spa, named Best Spa on a Cruise Ship by Spa finder Wellness 365TM. As part of our relaxing cruise activities, you can choose from a variety of treatments, such as aroma stone therapy massages and detoxifying ocean wraps. Or enjoy a manicure and pedicure in our salon with an attentive service chosen by you.

Lotus Spa Fitness Centre Our state-of-the-art fitness centers offer exercise and spinning courses, free and machine weights, treadmills with ocean views and more to energize yourself while on your cruise holiday. And if you like the outdoors, there's a jogging track a few decks above the waves.

The Princess Luxury Bed Created exclusively for Princess by a manufacturer renowned for some of the most comfortable hotel beds in the world, our luxurious new beds envelop guests in opulent style and blissful comfort. We've invested in ultra-premium features; a two-inch thick pillow top, a nine-inch single-sided medium firm mattress especially designed for enhanced support, individually wrapped bed coils for minimal disturbance, a European-inspired ultra soft duvet and 100% luxurious jacquard-woven cotton linens.



Activities and Entertainment

Camp Discovery Kids can enjoy our new youth centres in partnership with Discovery which are broken into 3 age categories: The Treehouse (Ages 3-7), The Lodge (Ages 8-12) and The Beach House (Ages 13-17)

Movies Under the Stars Watch new blockbusters and old favourites on this giant, poolside screen in our outdoor amphitheatre. 7.1 digital surround sound offers a fully immersive experience

Club Fusion When the sun goes down and the moon comes up, it's time to get your feet movin' and your heart pumpin' at Club Fusion. A little eclectic and a whole lot of fun, the dance floor lights and booming sound system invite you to get up and show off your moves and grooves. Karaoke contests, live performances and theme-parties like "60s British Invasion" are just a few of the nightly events that will have you on your feet.

Sports Court Feel the court under your feet and the thrill of victory as you sink the ball in for two points. No matter your athletic ability, there's nothing like shooting a few hoops out in the middle of the ocean as you watch the sun set and the stars come out. Our Sports Court is not only set up for basketball but also for volleyball.

Princess Theatre Watch West End style performances with shows such as Rock Opera. This one-of-a-kind production features incredible costumes inspired by glamorous avant-garde fashion with a musical soundtrack spanning classic rock, opera and musical



theater, sung in English, Spanish, Latin and even American Sign Language – a Princess first! And introducing 5-SKIES – one of our most technologically advanced production shows yet. Meet Gamer 1, who dares to take on "5-SKIES," the greatest virtual reality game of all time. Follow him on his journey through a series of increasingly difficult levels, encountering new characters and challenges along the way. Will he master all 5 skies to unlock each level and ultimately reach the Emerald Princess?



The Shops of Princess It's no surprise The Shops are awarded "Best Onboard Shopping" from Porthole magazine year after year. On board, you'll find a fabulous range of fine merchandise from brands like Swarovski, Chanel, Estée Lauder, Clinique, Lancôme, Calvin Klein, Citizen and Tissot, plus local crafts, keepsakes and souvenirs.

Casino From gaming lessons to the latest slot machines to prize tournaments, our Casinos offer fun and excitement for novices, casual players, or high rollers.

Your home away from home

From the moment you step aboard, we want you to feel welcomed and right at home. And with attentive service from our friendly staff that knows what hospitality means, you'll find that Emerald Princess truly is your home away from home.

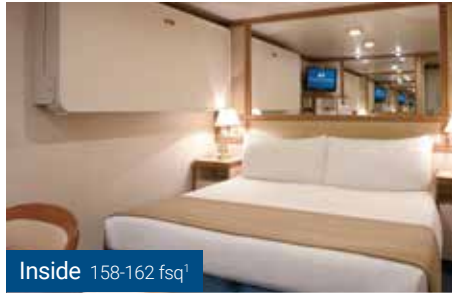

Inside 158-162 fsq¹



Oceanview 146-206 fsq¹



Balcony 214-222 fsq¹



Mini-suite 333 fsq¹



Suite 460-932 fsq¹

All staterooms have the following amenities:

Comfortable queen or twin beds¹ • Private bathroom and shower • Refrigerator • Flat screen TV • 100% cotton, high thread count linens • Complimentary 24 hour room service • Spacious closet • Desk • Hair dryer and fine bathroom amenities • Digital security safe • Evening bed turn-down with chocolates on your pillow • Complimentary shampoo, conditioner and body lotion • Fresh fruit • Waffle weave cloth bathrobes upon request • Standard US and European plug sockets • Many staterooms have Pullman foldaway beds which can accommodate a 3rd or 4th person

¹Size and position of stateroom will vary by ship. Images are a representation of a typical cabin within that grade. The Oceanview cabin image represents a slightly larger than usual stateroom within this category

Club Class Mini Suite

Upgraded bathroom amenities • Bath with overhead rain shower • Complimentary glass of Champagne on embarkation day

Club Class Dining • Premium location mini-suites • Priority embarkation and disembarkation at beginning and end of cruise • Priority speciality dining reservations • Complimentary in-room wine set up on embarkation day – ½ bottle of red and ½ bottle of white wine • Complimentary premium evening canapés upon request • Upgraded terry shawl bathrobes





Suite

In addition to Club Class Mini Suite: Upgraded bathroom amenities • Bath with overhead rain shower • Complimentary glass of Champagne on embarkation day • Priority embarkation and disembarkation including lounge • Priority tender embarkation • Luxury terry shawl bathrobes and slippers • Complimentary 1/2 bottle of wine per person • Evening canapés upon request • Club Class Dining • Priority shore excursion and speciality dining reservations • Priority queue at the Guest Services Desk • Complimentary same day laundry services and shoe polishing • Complimentary access to Lotus Spa thermal suite (on selected ships) • Complimentary speciality dining on embarkation day • 24-hour complimentary room service with upgraded menus • Complimentary one time Mini Bar set up and free daily bottled water • VIP priority onboard shore excursion reservations • VIP priority line at the guest service desk • VIP priority speciality dining reservations • Complimentary private portrait sitting with onboard photographer • Complimentary Lotus Spa Thermal Suite access on select ships • Complimentary umbrellas • Upgraded turn down service • Complimentary fresh orchids • Complimentary premium stationery and pens • Exclusive Concierge Lounge with complimentary hors d'oeuvres • Complimentary Chef's welcome goodies on embarkation evening • Complimentary in-suite afternoon tea • Complimentary exotic fruit bowl on embarkation day, refreshed upon request • Complimentary ice service twice daily

The Princess Luxury Bed

Experience the Most Comfortable Sleep at Sea with Princess Luxury Bed: Developed exclusively for Princess by the manufacturer of some of the most comfortable hotel beds in the world, our luxurious new beds will envelop guests in opulent style and pure, blissful comfort. We've invested in ultra-premium features including a plush two-inch thick pillow top, a nine-inch single sided medium firm mattress for enhanced support, individually wrapped coils for less partner disturbance, a European-inspired duvet and 100% luxurious Jacquard-woven cotton linens.



Deckplans

Built in Fincantieri Cantieri Navali Italiani, Monfalcone, Italy. Registered in Bermuda.

Length 951ft | Height 195ft | Gross tonnage 113,561 | 21.5 knots | 19 decks

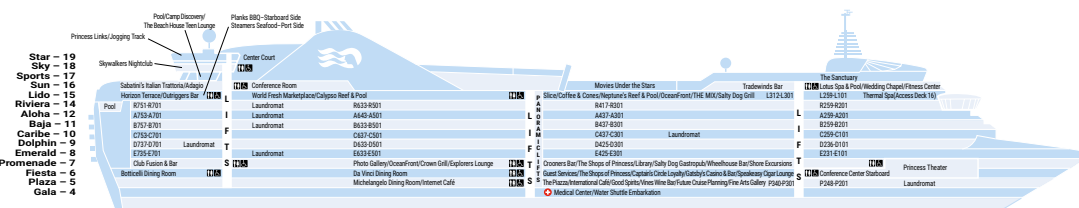

Stateroom description

Plans for Emerald Princess may vary, see princess.com for details.

- Suite
- S3

ALOHA, CARIBE
- S4

RIVIERA
- S6

CARIBE, DOLPHIN, EMERALD
- S8

DOLPHIN
- Mini- Suite - with balcony
- MF

DOLPHIN
- MB

DOLPHIN
- MC

EMERALD
- MD

DOLPHIN
- ME

DOLPHIN, EMERALD
- Balcony
- B1

CARIBE
- B2

CARIBE
- B4

BAJA, CARIBE, DOLPHIN, EMERALD
- B8

ALOHA, BAJA Two lower beds
- B9

ALOHA, BAJA Two lower beds
- B10

LIDO Two lower beds
- B11

ALOHA, BAJA, CARIBE Two lower beds
- B12

RIVIERA, ALOHA, BAJA, CARIBE Two lower beds
- B13

LIDO, RIVIERA Two lower beds

- Oceanview
- OB

EMERALD
- OC

PLAZA, PLAZA
- OE

RIVIERA, EMERALD
- OF

PLAZA
- OV

EMERALD
- OW

EMERALD
- OY

EMERALD
- OZ

LIDO
- Interior
- IA

ALOHA, BAJA, CARIBE Two lower beds
- IB

RIVIERA, ALOHA, BAJA, CARIBE, DOLPHIN Two lower beds
- IC

RIVIERA, LIDO, EMERALD, PLAZA
- ID

ALOHA, BAJA, CARIBE, DOLPHIN Two lower beds
- IE

RIVIERA, ALOHA, BAJA, CARIBE, DOLPHIN, EMERALD Two lower beds
- IF

RIVIERA, EMERALD, LIDO, EMERALD, PLAZA

- Will accommodate third and fourth person
- ▲

 Will accommodate third person
- ▲

 Connecting stateroom
- Wheelchair-accessible stateroom; shower only

- ★

 Two lower beds not convertible to queen; shower only
- Will accommodate a rollaway
- †

 Balcony door blocked when upper berth is in use
- ‡

 Balcony access when in port only

Note: Some areas of the ship are not accessible to wheelchairs and scooters. Distances shown are from the bow (forward) or stern (aft) to the nearest stateroom. Stateroom views are considered unobstructed unless noted otherwise. Obstructions do not include certain nautical items like handrails, dividers or ship hardware. For balcony staterooms, the view is determined from the perspective of the balcony railing. Balconies may have either solid steel or toughened glass railing.

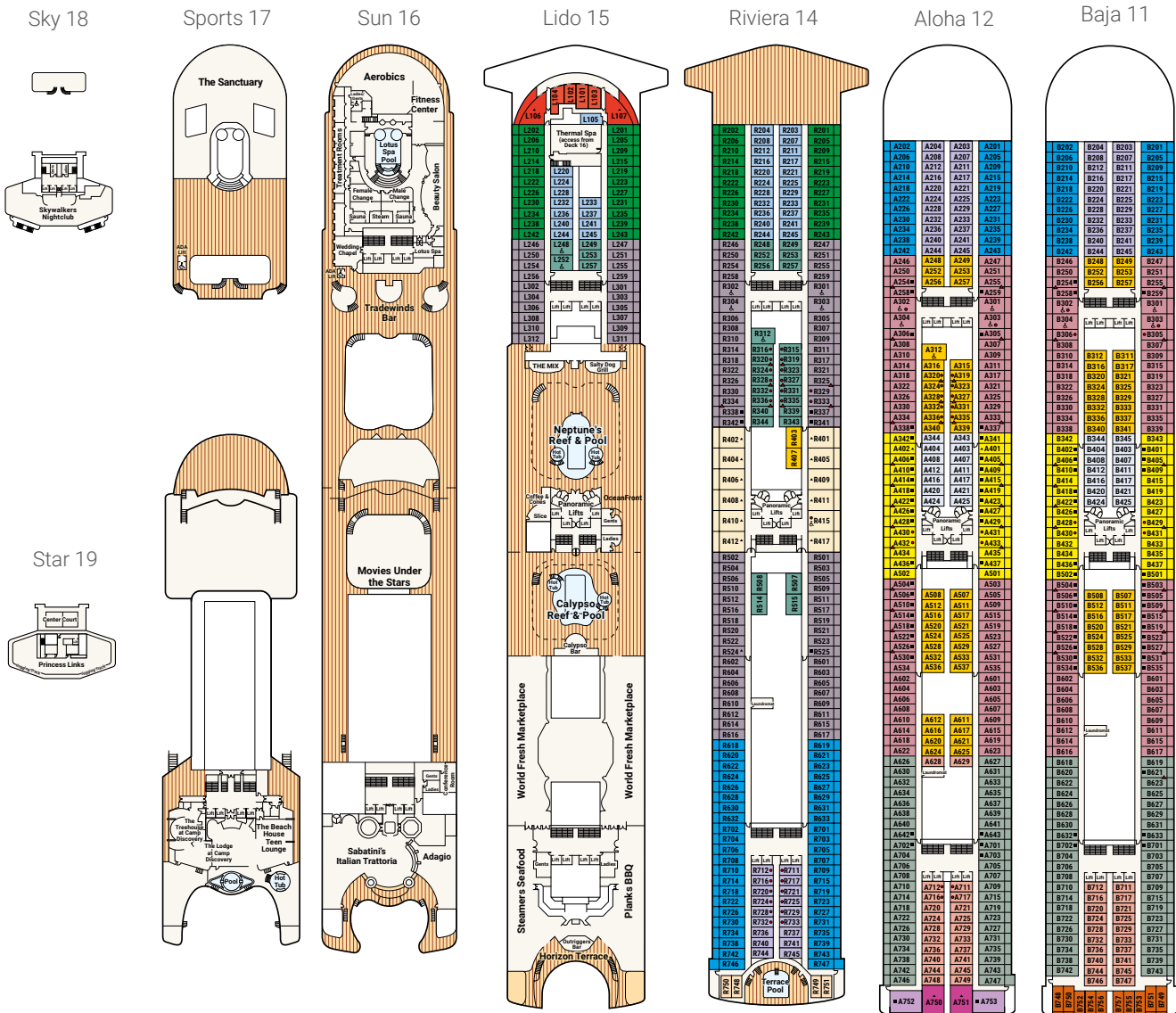

Deckplans

Built in Fincantieri Cantieri Navali Italiani, Monfalcone, Italy. Registered in Bermuda.
Length 951ft | Height 195ft | Gross tonnage 113,561 | 21.5 knots | 19 decks

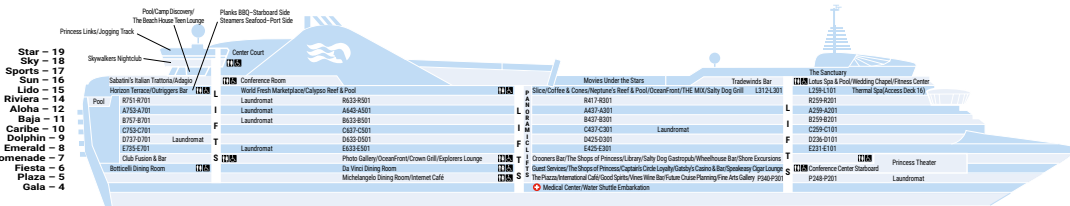

Stateroom description

Plans for Emerald Princess may vary, see princess.com for details.

- Suite
- S3** ALOHA, CARIBE
 - S4** RIVIERA
 - S6** CARIBE, DOLPHIN, EMERALD
 - S8** DOLPHIN
- Mini- Suite - with balcony
- M1** DOLPHIN
 - M2** DOLPHIN
 - M3** EMERALD
 - M4** DOLPHIN
 - M5** DOLPHIN, EMERALD
- Balcony
- B1** CARIBE
 - B2** CARIBE
 - B4** BAJA, CARIBE, DOLPHIN, EMERALD
 - B5** ALOHA, BAJA Two lower beds
 - B6** ALOHA, BAJA Two lower beds
 - B7** LIDO Two lower beds
 - B8** ALOHA, BAJA, CARIBE Two lower beds
 - B9** RIVIERA, ALOHA, BAJA, CARIBE Two lower beds
 - B10** LIDO, RIVIERA Two lower beds

- Oceanview
- O1** EMERALD
 - O2** PLAZA, PLAZA
 - O3** RIVIERA, EMERALD
 - O4** PLAZA
 - O5** EMERALD
 - O6** EMERALD
 - O7** EMERALD
 - O8** LIDO
- Interior
- I1** ALOHA, BAJA, CARIBE Two lower beds
 - I2** RIVIERA, ALOHA, BAJA, CARIBE, DOLPHIN Two lower beds
 - I3** RIVIERA, LIDO, EMERALD, PLAZA
 - I4** ALOHA, BAJA, CARIBE, DOLPHIN Two lower beds
 - I5** RIVIERA, ALOHA, BAJA, CARIBE, DOLPHIN, EMERALD Two lower beds
 - I6** RIVIERA, EMERALD, LIDO, EMERALD, PLAZA

- Will accommodate third and fourth person
- ▲ Will accommodate third person
- ▲ Connecting stateroom
- Wheelchair-accessible stateroom; shower only

- * Two lower beds not convertible to queen; shower only
- ▲ Will accommodate a rollaway
- † Balcony door blocked when upper berth is in use
- † Balcony access when in port only

Note: Some areas of the ship are not accessible to wheelchairs and scooters. Distances shown are from the bow (forward) or stern (aft) to the nearest stateroom. Stateroom views are considered unobstructed unless noted otherwise. Obstructions do not include certain nautical items like handrails, dividers or ship hardware. For balcony staterooms, the view is determined from the perspective of the balcony railing. Balconies may have either solid steel or toughened glass railing.

Caribe 10

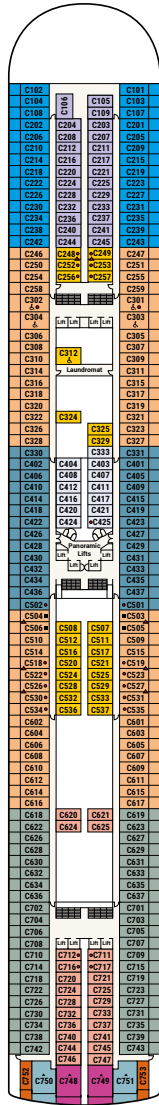

Dolphin 9

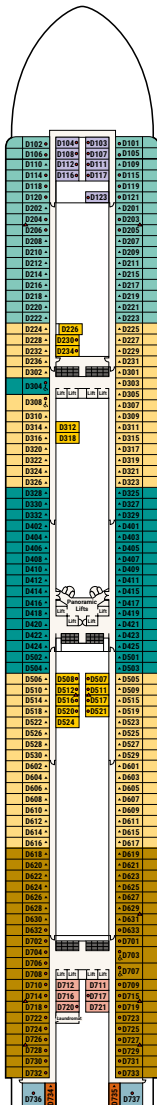

Emerald 8

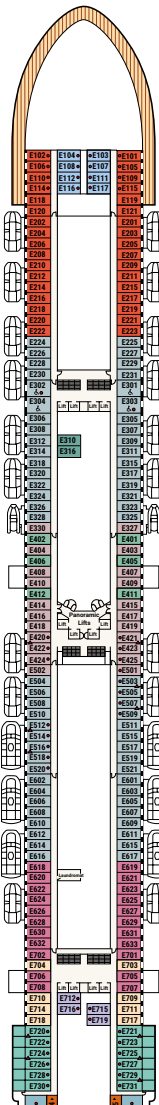

Promenade 7

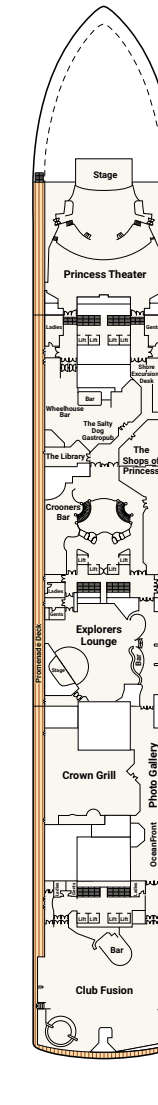

Fiesta 6

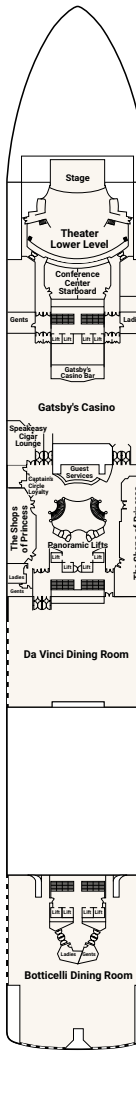

Plaza 5

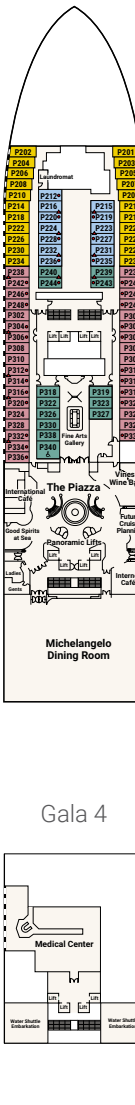

Gala 4

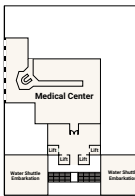



*We hope you have a wonderful time sailing on
board Emerald Princess*

